

## Flow Switch, Inline Type

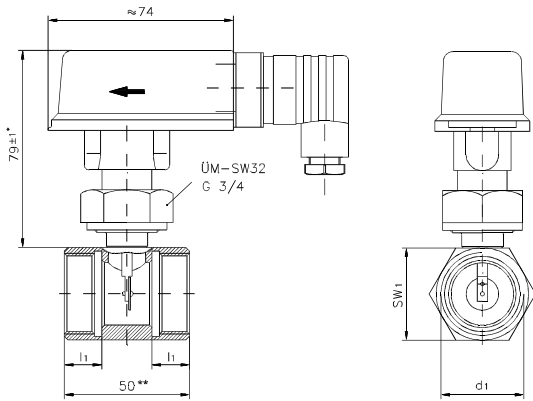

\* stainless steel version: 82 ± 1  
 \*\* 60 mm at VHS 15 MA:

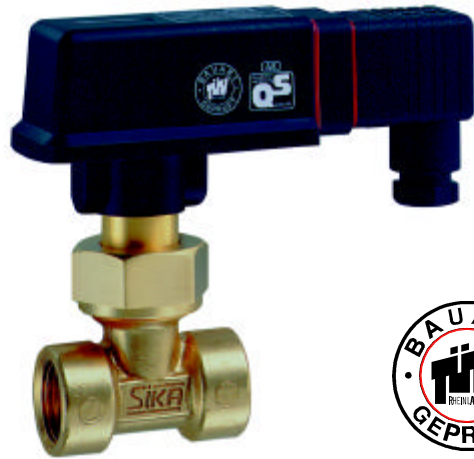

| Type/<br>Order<br>code | Size  | Process<br>connection<br>d1 | Setpoint ranges (H <sub>2</sub> O, 20°C) |                            | Max.<br>flow<br>rate<br>[l/min] | Dimensions     |                               |                    |
|------------------------|-------|-----------------------------|--|----------------------------|---------------------------------|----------------|-------------------------------|--------------------|
|                        |       |                             | increasing flow<br>[l/min]               | decreasing flow<br>[l/min] |                                 | l <sub>1</sub> | Nut size sw <sub>1</sub> [mm] |                    |
|                        |       |                             |  |                            |                                 |                | Brass                         | Stainless<br>steel |
| VHS 08 M               | DN 8  | 1/4" BSP                    | 2,1...2,7                                | 1,8...2,4                  | 45                              | 11             | 27                            | 27                 |
| VHS 10 M               | DN 10 | 3/8" BSP                    | 2,5...3,2                                | 2,2...2,9                  | 60                              | 11             | 19                            | 27                 |
| VHS 15 M               | DN 15 | 1/2" BSP                    | 3,4...4,2                                | 3,0...3,8                  | 67                              | 11             | 19                            | 27                 |
| VHS 15 MA              | DN 15 | 1/2" BSP male               | 2,5...3,2                                | 2,2...2,9                  | 60                              | 10             | 19                            | —                  |
| VHS 20 M               | DN 20 | 3/4" BSP                    | 7,0...9,1                                | 6,4...8,2                  | 180                             | 15             | 27                            | 32                 |
| VHS 25 M               | DN 25 | 1" BSP                      | 13,5...17,0                              | 12,0...15,5                | 195                             | 15             | 32                            | 41                 |
| VHS 32 M               | DN 32 | 1 1/4" BSP                  | 15,5...20,5                              | 14,5...19,0                | 240                             | 15             | 46                            | 46                 |
| VHS 40 M               | DN 40 | 1 1/2" BSP                  | 26,5...34,5                              | 25,5...32,5                | 400                             | 15             | 55                            | 55                 |
| VHS 50 M               | DN 50 | 2" BSP                      | 39,5...51,0                              | 39,0...50,0                | 400                             | 15             | 70                            | 70                 |

## Materials and pressure drop diagram

| Type        | Material        |                 |                 |
|-------------|-----------------|-----------------|-----------------|
|             | Upper section   | Paddle system   | Pipe section    |
| VHS .. M-MS | Brass           | Brass           | Brass*          |
| VHS .. M-VA | Stainless steel | Stainless steel | Stainless steel |
| VHS .. MK   | Brass           | PPO Noryl GFN3  | Brass*          |
| VKS .. M    | PPO Noryl GFN3  | PPO Noryl GFN3  | Brass*          |

\* As an option, a copper tee piece, for soldered connections, can be supplied. This will alter the specified setpoint ranges.

